

RENOLD SD

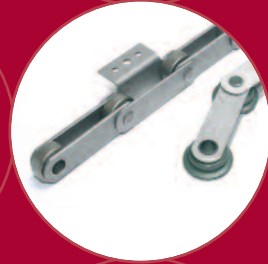

RENOLD
Superior Chain Technology

Renold SD

The new “Standard” in the economy category of chain

If you are looking for a good quality product from a reliable supplier for “standard duty” chain applications, look to **RENOLD SD**, the new benchmark in the economy chain category.

Renold is recognized as the worldwide leader in chain products and has established manufacturing facilities across the globe. While most suppliers buy-in their economy line of chain, Renold manufactures its own.

The Renold SD range offers:

- An extensive product line of European (BS), ANSI and DIN standard chains
- Competitive prices and delivery
- Consistent quality
- Depth of inventory



Transmission Chain



Multi-strand Chain



Conveyor Chain



Nickel Plated Chain



Stainless Steel Chain

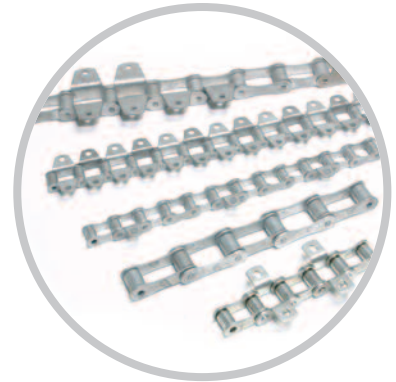

Agricultural Chain

Renold SD

European (BS) Standard / ANSI Standard

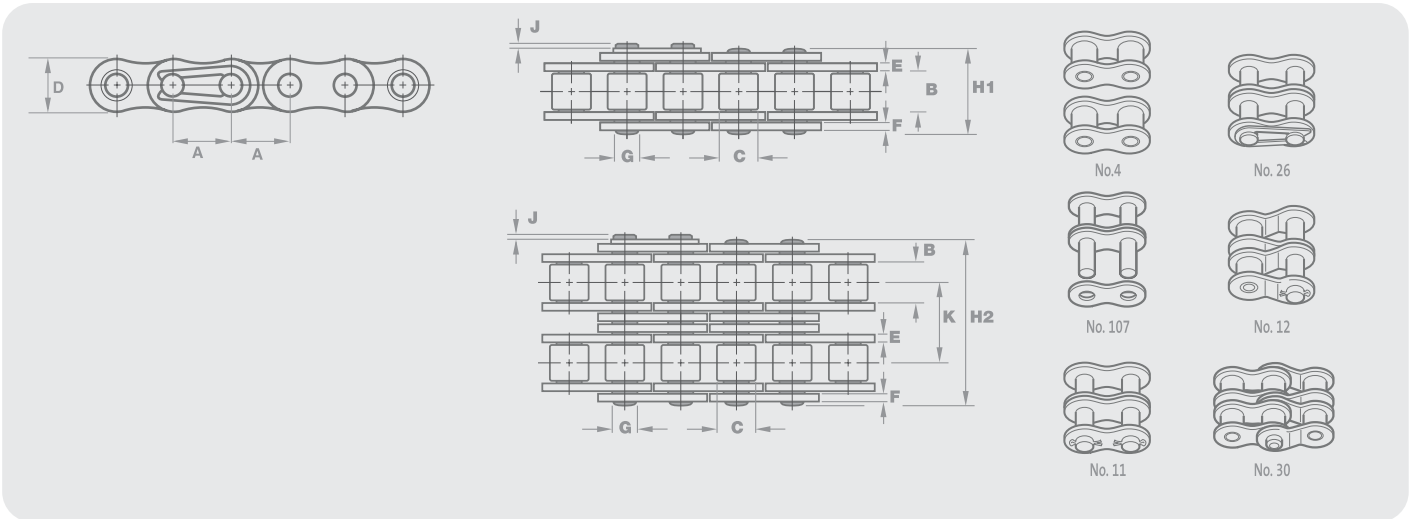

European (BS) Standard - Simplex

Dimensions (mm)

Renold SD Chain No.	Pitch mm	Pitch inch	Inside Width	Roller Diameter	Inner Plate Depth	Pin Diameter	Pin Length	Pin Length	ISO Tensile Strength (Min)	Weight Per Metre kg/m
	A	A	B	C	D	G	H1	J1		
SD05B-1	8.00	0.315	3.00	5.00	7.11	2.31	8.00	8.9	4400	0.20
SD06B-1*	9.525	0.375	5.72	6.35	8.20	3.28	13.20	14.2	8900	0.41
SD08B-1	12.70	0.500	7.75	8.51	11.80	4.45	16.70	18.0	17800	0.69
SD10B-1	15.875	0.625	9.65	10.16	14.70	5.08	19.60	21.0	22200	0.93
SD12B-1	19.05	0.750	11.68	12.07	16.10	5.72	22.50	24.0	28900	1.15
SD16B-1	25.40	1.000	17.02	15.88	21.05	8.28	36.00	37.2	60000	2.71
SD20B-1	31.75	1.250	19.56	19.05	26.31	10.19	41.10	44.7	95000	3.70
SD24B-1	38.10	1.500	25.40	25.40	33.30	14.63	53.30	57.5	160000	7.10
SD28B-1	44.45	1.750	30.99	27.94	36.90	15.90	64.80	69.5	200000	8.50
SD32B-1	50.80	2.000	30.99	29.21	42.10	17.81	66.20	71.0	250000	10.25

European (BS) Standard - Duplex

Dimensions (mm)

	A	A	B	C	D	G	H2	J2		
SD06B-2*	9.525	0.375	5.72	6.35	8.20	3.28	23.5	24.5	16000	0.77
SD08B-2	12.70	0.500	7.75	8.51	11.80	4.45	31.0	32.1	31100	1.34
SD10B-2	15.875	0.625	9.65	10.16	14.70	5.08	36.2	37.5	44500	1.84
SD12B-2	19.05	0.750	11.68	12.07	16.10	5.72	42.1	43.6	57800	2.31
SD16B-2	25.40	1.000	17.02	15.88	21.05	8.28	67.5	69.1	106000	5.42
SD20B-2	31.75	1.250	19.56	19.05	26.30	10.19	77.2	80.9	170000	7.20
SD24B-2	38.10	1.500	25.40	25.40	33.30	14.63	101.6	105.9	280000	13.40
SD28B-2	44.45	1.750	30.99	27.94	36.90	15.90	124.1	129.1	360000	16.60
SD32B-2	50.80	2.000	30.99	29.21	42.10	17.81	124.6	129.6	450000	21.00

ANSI Standard - Simplex

Dimensions (mm)

Renold SD Chain No.	Pitch mm	Pitch inch	Inside Width	Roller Diameter	Inner Plate Depth	Pin Diameter	Pin Length	Pin Length	ISO Tensile Strength (Min)	Weight Per Metre kg/m
	A	A	B	C	D	G	H1	J1		
SD25-1*	6.35	0.250	3.18	3.30	5.90	2.31	7.80	8.45	3500	0.15
SD35-1*	9.525	0.375	4.77	5.08	8.95	3.58	12.15	13.10	7900	0.33
SD41-1	12.70	0.500	6.25	7.77	9.90	3.58	13.75	15.40	6700	0.41
SD40-1	12.70	0.500	7.85	7.95	11.90	3.96	16.60	17.75	13900	0.62
SD50-1	15.875	0.625	9.40	10.16	15.09	5.08	20.90	22.20	21800	1.02
SD60-1	19.05	0.750	12.57	11.91	18.00	5.94	25.90	27.50	31300	1.50
SD80-1	25.40	1.000	15.75	15.88	24.10	7.92	32.80	34.90	55600	2.60
SD100-1	31.75	1.250	18.90	19.05	30.10	9.53	40.00	43.20	87000	3.91
SD120-1	38.10	1.500	25.22	22.23	36.10	11.10	50.45	53.40	125000	5.62
SD140-1	44.45	1.750	25.22	25.40	42.00	12.70	54.90	54.20	170000	7.50
SD160-1	50.80	2.000	31.55	28.58	48.00	14.27	65.50	64.30	223000	10.10

ANSI Standard - Duplex

Dimensions (mm)

	A	A	B	C	D	G	H2	J2		
SD40-2	12.70	0.500	7.85	7.95	11.90	3.96	31.10	32.25	27800	1.12
SD50-2	15.875	0.625	9.40	10.16	15.00	5.08	39.00	40.30	43600	2.00
SD60-2	19.05	0.750	12.57	11.91	18.00	5.94	48.80	50.30	62600	2.92
SD80-2	25.40	1.000	15.75	15.88	24.10	7.92	61.90	64.20	111200	5.15
SD100-2	31.75	1.250	18.90	19.05	30.10	9.53	76.20	80.50	174000	7.80
SD120-2	38.10	1.500	25.22	22.23	36.00	11.10	95.40	99.70	250000	11.70
SD140-2	44.45	1.750	25.22	25.40	42.00	12.70	103.10	107.90	340000	15.14
SD160-2	50.80	2.000	31.55	28.58	48.00	14.27	122.90	128.10	446000	20.14

*Straight side plate

Australia**Melbourne (Victoria)**

Tel: + 61 (0) 3 9262 3333
Fax: + 61 (0) 3 9561 8561
e-mail: melsmg@renold.com.au

*also at: Sydney, Brisbane, Adelaide, Perth,
Newcastle, Wollongong, Townsville*

Austria**Vienna**

Tel: + 43 (0) 1 330 3484
Fax: + 43 (0) 1 330 3484-5
e-mail: office@renold.at

*also at: Budapest (Hungary),
Zlin (Czech Republic)*

Belgium**Brussels**

Tel: + 32 (0) 2 201 1262
Fax: + 32 (0) 2 203 2210
e-mail: info@renold.be

Canada**Brantford (Ontario)**

Tel: + 1 519 756 6118
Fax: + 1 519 756 1767
e-mail: inquiry@renoldcanada.com

also at: Montreal

China**Shanghai**

Tel: + 21 5046 2696
Fax: + 21 5046 2695
e-mail: sales@renold.cn

France**Seclin**

Tel: + 33 (0) 320 16 29 29
Fax: + 33 (0) 320 16 29 00
e-mail: contact@brampton-renold.com

Germany**Einbeck**

Tel: + 49 (0) 5562 810
Fax: + 49 (0) 5562 81130
e-mail: info@renold.de

also at: Düsseldorf

India**Coimbatore**

Tel: +91 - 422 2532325 / 3911108
Fax: +91 - 422 2532333 / 2534470
e-mail: marketing@renold.in

Malaysia**Selangor Darul Ehsan**

Tel: + 60 3-5122 7880
Fax: + 60 3-5122 7881
e-mail: sales@renoldmalaysia.com

also at: Johor Bharu, Ipoh, Penang

Netherlands**Amsterdam**

Tel: + 31 (0) 20 6146661
Fax: + 31 (0) 20 6146391
e-mail: info@renold.nl

New Zealand**Auckland**

Tel: + 64 9828 5018
Fax: + 64 9828 5019
e-mail: aksales@renold.co.nz

also at: Christchurch

Philippines**Paranaque City**

Tel: + 63 2 829 6086
Fax: + 63 2 826 5211

Poland**c/o Einbeck (Germany)**

Tel: + 48 663 842 487

Russia**Moscow**

Tel: + 7 495 645 2250
Fax: + 7 495 645 2251
e-mail: info@renold.ru

Scandinavia**Hvidovre (Copenhagen)**

Tel: + 45 43 45 26 11
Fax: + 45 43 45 65 92
e-mail: infor@renold.com

Singapore

Tel: + 65 6760 2422
Fax: + 65 6760 1507
e-mail: sales@renold.sg

South Africa**Benoni (Johannesburg)**

Tel: + 27 11 747 9500
Fax: + 27 11 747 9505
e-mail: sales@renold.co.za

*also at: Richards Bay,
Port Elizabeth, Cape Town*

Spain**Gavá (Barcelona)**

Tel: + 34 93 638 9641
Fax: + 34 93 638 0737
e-mail: spain@renold.com

Switzerland**Dübendorf (Zürich)**

Tel: + 41 (0) 44 824 8484
Fax: + 41 (0) 44 824 8411
e-mail: duebendorf@renold.com

also at: Crissier (Lausanne)

UK**Burton upon Trent**

Tel: + 44 (0) 1283 512940
Fax: + 44 (0) 1283 512628
e-mail: ukchain@renold.com

USA**Morristown TN**

Tel: + 1 800 251 9012
Fax: + 1 423 581 2399
e-mail: sales@renoldjeffrey.com

*For other country distributors please consult
www.renold.com.*

*Whilst all reasonable care is taken in compiling
the information contained in this brochure, no
responsibility is accepted for printing errors.*

*All information contained in this brochure is
subject to change after the date of publication.*

© Renold Power Transmission 2009.
Ref: REN52 / ENG / 02.09

RENOLD
Superior Chain Technology